

WL-M

THROUGH CONNECTOR, PRE-INSULATED WITH HEAT-SHRINK PE HD, FOR COPPER CONDUCTORS, HALOGEN FREE, IP68



Features

TECHNICAL INFORMATION

| | |
|-------------------------------|----------------------------|
| Minimum operating temperature | -40°C |
| Maximum operating temperature | 105°C |
| Type of connector | parallel through connector |
| Type of insulation | full |
| Surface treatment | tin plating |
| Vibration resistant | Yes |
| Crimping geometry | radial |

WEIGHT AND DIMENSIONS

| | |
|----------------------------|-------|
| Full shrinkage temperature | 150°C |
| Barrel length | 15mm |
| Cable stripping length | 9mm |
| Nominal voltage | 600V |

CLASSIFICATION AND DATA ORDERING

| | |
|--------------|----------|
| Customs code | 85369010 |
|--------------|----------|

MATERIAL COMPOSITION AND TREATMENTS

| | |
|--------------------------|--|
| Conductor body material | Rame elettrolitico con purezza superiore al 99,95% |
| Insulated cover material | Polyethylene HDPE |
| Annealing | Yes |
| Halogen free | Yes |

LOGISTIC

| | |
|---------------------------|--------|
| Unit in minimal packaging | 100PCE |
|---------------------------|--------|

CERTIFICATIONS

| | |
|--|------|
| ROHS compliant | Yes |
| Self-extinguishing fire class according to UL 94 | HB |
| Ingress Protection | IP68 |

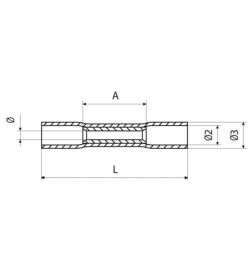

WL-M

| tipo | Insulated cover colour | Range of cable cross section [mm²] | L [mm] | C [mm] | Ø [mm] | Unit in standard packaging [pce] |
|--------|------------------------|------------------------------------|--------|--------|--------|----------------------------------|
| WL03-M | red | 0.5 - 1.5 | 36 | 36 | 1.7 | 1500 |
| WL06-M | blue | 1.5 - 2.5 | 36 | 36 | 2.3 | 1000 |
| WL1-M | yellow | 4 - 6 | 41 | 41 | 3.5 | 500 |



