

PL-M

THROUGH CONNECTOR, PRE-INSULATED WITH PVC, FOR COPPER CONDUCTORS



CERTIFICATIONS & APPROVALS



Features

TECHNICAL INFORMATION

Minimum operating temperature	-20°C
Maximum operating temperature	80°C
Threshold of operating temperature for short periods	90°C
Type of connector	butt through connector
Central stop	Yes
Type of insulation	full
Surface treatment	tin plating
Crimping geometry	radial

MATERIAL COMPOSITION AND TREATMENTS

Conductor body material	Rame elettrolitico con purezza superiore al 99,95%
Insulated cover material	Polyvinylchloride PVC
Annealing	Yes

WEIGHT AND DIMENSIONS

Cable stripping length	9mm
------------------------	-----

LOGISTIC

Unit in minimal packaging	100PCE
---------------------------	--------

CLASSIFICATION AND DATA ORDERING

Customs code	85369010
--------------	----------

CERTIFICATIONS

ROHS compliant	Yes
----------------	-----

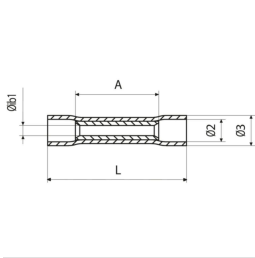

PL-M

tipo	Insulated cover colour	Range of cable cross section [mm ²]	Ø [mm]	Ø2 [mm]	L [mm]	A [mm]	C [mm]	Ø2 [mm]	Ø3 [mm]	Unit in standard packaging [pce]	Self-extinguishing fire class according to UL 94	UL standard
PL01-M	green	0.2 - 0.5	2.15	1.15	25	15	25	3	3.8	3000		
PL03-M	red	0.25 - 1.5	3.3	1.8	25	15	25	4	4.7	1000	V0	486C
PL06-M	blue	1.5 - 2.5	4	2.42	25	15	25	5	6.9	1500	V0	486C
PL1-M	yellow	4 - 6	5.25	3.6	32	16	32	6.5	7	500	V0	486C



