

L-P

PARALLEL CONNECTORS, FOR COPPER CONDUCTORS



Features

TECHNICAL INFORMATION

Minimum operating temperature	-50°C
Maximum operating temperature	150°C
Type of connector	parallel through connector
Easy insertion input	Yes
Surface treatment	tin plating

MATERIAL COMPOSITION AND TREATMENTS

Conductor body material	Rame elettrolitico con purezza superiore al 99,95%
Annealing	Yes

CLASSIFICATION AND DATA ORDERING

Customs code	85369010
--------------	----------

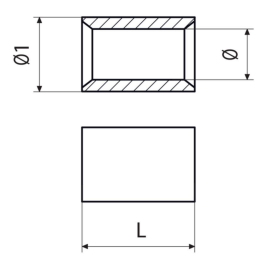

L-P

tipo	Crimping geometry	Range of cable cross section (flexible) [mm ²]	Range of cable cross section (low stranded) [mm ²]	L [mm]	A [mm]	Ø [mm]	Cable stripping length [mm]	Ø1 [mm]	Unit in minimal packaging [pce]	Unit in standard packaging [pce]	ROHS compliant
L03-P	hexagonal; indent	0.25 - 1.5	0.25 - 1.5	6	6	1.8	7	3.3	100	8000	Yes
L06-P	hexagonal; indent	1.5 - 2.5	1.5 - 2.5	6	6	2.42	7	4	100	5000	Yes
L1-P	hexagonal; indent	4 - 6	4 - 6	9	9	3.6	10	5.25	100	3000	Yes
L2-P	hexagonal; indent	10	10	10.5	10.5	4.6	12	6.8	100	2000	Yes
L3-P	hexagonal; indent	16	16	11.5	11.5	5.8	13	7.9	100	1500	Yes
L5-P	hexagonal; indent	25	25	13	13	7	15	9.3	100	1000	Yes
L7-P	hexagonal; indent	25 - 35	35	14	14	8.9	16	11.7	100	500	Yes
L10-P	hexagonal; indent	35 - 50	50	16	16	10	18	13	100	500	Yes
L14-P	hexagonal; indent	50 - 70	70	18	18	11.3	20	14.6	100	500	Yes
L19-P	hexagonal; indent	70 - 95	95	19	19	13.5	21	17.5	50	200	Yes
L24-P	hexagonal; indent	95 - 120	120	22	22	15.2	25	19.6	50	200	Yes
L30-P	hexagonal; indent	120 - 150	150	26.5	26.5	16.7	30	21.5	50	100	Yes
L37-P	hexagonal; indent	150 - 185	185	26.5	26.5	19.2	30	24.4	50	100	Yes
L48-P	hexagonal; indent	185 - 240	240	34	34	21.1	38	27.2	15	60	Yes
L60-P	hexagonal; indent	240 - 300	300	43	43	23.7	48	30.6	25	50	Yes