

KF-FP

REINFORCED FEMALE DISCONNECT CONNECTOR, FULLY INSULATED IN PA6.6, FOR COPPER CONDUCTORS



Features

TECHNICAL INFORMATION

Minimum operating temperature	-20°C
Maximum operating temperature	105°C
Threshold of operating temperature for short periods	110°C
Barrel reinforcement ring	Yes
Type of insulation	full
Easy insertion input	Yes
Surface treatment	tin plating
Reinforced with anti-vibration collar	Yes
Crimping geometry	radial

MATERIAL COMPOSITION AND TREATMENTS

Conductor body material	brass
Halogen free	Yes

LOGISTIC

Unit in minimal packaging	100PCE
---------------------------	--------

CLASSIFICATION AND DATA ORDERING

Customs code	85366990
--------------	----------

CERTIFICATIONS

ROHS compliant	Yes
EN 45545-2 certification	HL1

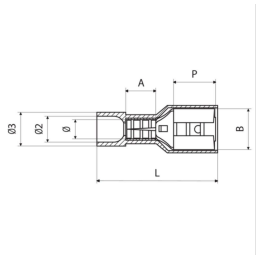

RKF-FP Insulated cover colour **red** Range of cable cross section [mm²] **0.25**

tipo	Tongue width [mm]	Tongue length [mm]	L [mm]	C [mm]	Ø2 [mm]	Ø [mm]	Cable stripping length [mm]	Unit in standard packaging [pce]
RKF-F408P	4.8	4.8	20.2	20.2	4	1.7	7	2000
RKF-F405P	4.8	4.8	20.2	20.2	4	1.7	7	1500
RKF-F608P	6.35	6.35	21.5	21.5	4	1.7	7	1000

BKF-FP Insulated cover colour **blue** Range of cable cross section [mm²] **1.5**

tipo	Tongue width [mm]	Tongue length [mm]	L [mm]	C [mm]	Ø2 [mm]	Ø [mm]	Cable stripping length [mm]	Unit in standard packaging [pce]
BKF-F405P	4.8	4.8	20.2	20.2	5	2.3	7	1500
BKF-F408P	4.8	4.8	20.2	20.2	5	2.3	7	2000
BKF-F608P	6.3	6.35	21.5	21.5	5	2.3	7	1000

GKF-FP Insulated cover colour **yellow** Range of cable cross section [mm²] **4**

tipo	Tongue width [mm]	Tongue length [mm]	L [mm]	C [mm]	Ø2 [mm]	Ø [mm]	Cable stripping length [mm]	Unit in standard packaging [pce]
GK-F608P	6.35	6.35	24.2	24.2	6.5	3.4	9	1000



Via Serenissima, 9 - 25135
Brescia - ITALY