

T-L

RING TERMINAL, 90° BEND, FOR COPPER CONDUCTORS



Features

TECHNICAL INFORMATION

Minimum operating temperature	-50°C
Maximum operating temperature	150°C
Spy hole	Yes
Bend angle of the connection	90°
Number of holes on the palm	1
Easy insertion input	Yes
Surface treatment	tin plating
Crimping geometry	hexagonal; indent

MATERIAL COMPOSITION AND TREATMENTS

Conductor body material	Rame elettrolitico con purezza superiore al 99,95%
Annealing	Yes

CLASSIFICATION AND DATA ORDERING

Customs code	85369010
--------------	----------

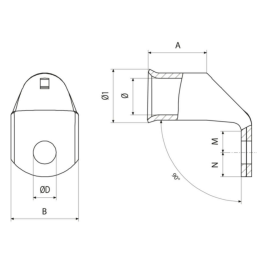

T6-L		Range of cable cross section (flexible) [mm ²] 4					Range of cable cross section (low stranded) [mm ²] 4							
tipo	Screw diameter	ØD [mm]	B [mm]	N [mm]	M [mm]	Tightening torque (high conductivity screw) [nm]	Tightening torque (8.8 grade screw) [nm]	A [mm]	Ø [mm]	Cable stripping length [mm]	Ø1 [mm]	Unit in minimal packaging [pce]	Unit in standard packaging [pce]	
T6-L6	M6	6.4	13	8	9	5	7	14.5	3.3	16	5.6	100	800	

T10-L		Range of cable cross section (flexible) [mm ²] 10					Range of cable cross section (low stranded) [mm ²] 10							
tipo	Screw diameter	ØD [mm]	B [mm]	N [mm]	M [mm]	Tightening torque (high conductivity screw) [nm]	Tightening torque (8.8 grade screw) [nm]	A [mm]	Ø [mm]	Cable stripping length [mm]	Ø1 [mm]	Unit in minimal packaging [pce]	Unit in standard packaging [pce]	
T10-L6	M6	6.4	11	8	9	5	7	14.5	4.2	16	6.8	100	800	
T10-L8	M8	8.3	14	10	11	10	20	14.5	4.2	16	6.8	100	800	

T16-L		Range of cable cross section (flexible) [mm ²] 16					Range of cable cross section (low stranded) [mm ²] 16							
tipo	Screw diameter	ØD [mm]	B [mm]	N [mm]	M [mm]	Tightening torque (high conductivity screw) [nm]	Tightening torque (8.8 grade screw) [nm]	A [mm]	Ø [mm]	Cable stripping length [mm]	Ø1 [mm]	Unit in minimal packaging [pce]	Unit in standard packaging [pce]	
T16-L6	M6	6.4	12	8	9	5	7	17	5.3	19	8	100	100	
T16-L8	M8	8.3	16	10	11	10	20	17	5.3	19	8	100	400	
T16-L10	M10	10.3	16	12	14	20	35	17	5.3	19	8	100	400	

T25-L		Range of cable cross section (flexible) [mm ²] 25					Range of cable cross section (low stranded) [mm ²] 25							
tipo	Screw diameter	ØD [mm]	B [mm]	N [mm]	M [mm]	Tightening torque (high conductivity screw) [nm]	Tightening torque (8.8 grade screw) [nm]	A [mm]	Ø [mm]	Cable stripping length [mm]	Ø1 [mm]	Unit in minimal packaging [pce]	Unit in standard packaging [pce]	
T25-L10	M10	10.3	16	10	14	20	35	17	6.6	19	9.5	100	400	
T25-L6	M6	6.4	13	6	9	5	7	17	6.6	19	9.5	100	400	
T25-L8	M8	8.3	16	8	11	10	20	17	6.6	19	9.5	100	400	

T35-L		Range of cable cross section (flexible) [mm ²] 35					Range of cable cross section (low stranded) [mm ²] 35							
tipo	Screw diameter	ØD [mm]	B [mm]	N [mm]	M [mm]	Tightening torque (high conductivity screw) [nm]	Tightening torque (8.8 grade screw) [nm]	A [mm]	Ø [mm]	Cable stripping length [mm]	Ø1 [mm]	Unit in minimal packaging [pce]	Unit in standard packaging [pce]	
T35-L6	M6	6.4	15	8	9	5	7	18	7.9	20	11	50	400	
T35-L8	M8	8.3	17	10	11	10	20	18	7.9	20	11	50	200	

tipo	Screw diameter	ØD [mm]	B [mm]	N [mm]	M [mm]	Tightening torque (high conductivity screw) [nm]	Tightening torque (8.8 grade screw) [nm]	A [mm]	Ø [mm]	Cable stripping length [mm]	Ø1 [mm]	Unit in minimal packaging [pce]	Unit in standard packaging [pce]
T35-L10	M10	10.3	17	12	14	20	35	18	7.9	20	11	50	200
T50-L	Range of cable cross section (flexible) [mm ²] 50					Range of cable cross section (low stranded) [mm ²] 50							
tipo	Screw diameter	ØD [mm]	B [mm]	N [mm]	M [mm]	Tightening torque (high conductivity screw) [nm]	Tightening torque (8.8 grade screw) [nm]	A [mm]	Ø [mm]	Cable stripping length [mm]	Ø1 [mm]	Unit in minimal packaging [pce]	Unit in standard packaging [pce]
T50-L6	M6	6.4	18	8	9	5	7	22.5	9.2	25	12.5	25	100
T50-L8	M8	8.3	18	10	11	10	20	22.5	9.2	25	12.5	25	200
T50-L10	M10	10.3	18	12	14	20	35	22.5	9.2	25	12.5	25	100
T70-L	Range of cable cross section (flexible) [mm ²] 70					Range of cable cross section (low stranded) [mm ²] 70							
tipo	Screw diameter	ØD [mm]	B [mm]	N [mm]	M [mm]	Tightening torque (high conductivity screw) [nm]	Tightening torque (8.8 grade screw) [nm]	A [mm]	Ø [mm]	Cable stripping length [mm]	Ø1 [mm]	Unit in minimal packaging [pce]	Unit in standard packaging [pce]
T70-L8	M8	8.3	21	10	11	10	20	19	11	21	15	25	100
T70-L10	M10	10.3	21	12	14	20	35	19	11	21	15	25	100
T70-L12	M12	12.8	21	16	18	40	50	24	11	27	15	25	100
T95-L	Range of cable cross section (flexible) [mm ²] 95					Range of cable cross section (low stranded) [mm ²] 95							
tipo	Screw diameter	ØD [mm]	B [mm]	N [mm]	M [mm]	Tightening torque (high conductivity screw) [nm]	Tightening torque (8.8 grade screw) [nm]	A [mm]	Ø [mm]	Cable stripping length [mm]	Ø1 [mm]	Unit in minimal packaging [pce]	Unit in standard packaging [pce]
T95-L10	M10	10.3	23	12	14	20	35	28	13.1	31	17	25	100
T95-L12	M12	12.8	23	16	18	40	50	28	13.1	31	17	25	100
T120-L	Range of cable cross section (flexible) [mm ²] 120					Range of cable cross section (low stranded) [mm ²] 120							
tipo	Screw diameter	ØD [mm]	B [mm]	N [mm]	M [mm]	Tightening torque (high conductivity screw) [nm]	Tightening torque (8.8 grade screw) [nm]	A [mm]	Ø [mm]	Cable stripping length [mm]	Ø1 [mm]	Unit in minimal packaging [pce]	Unit in standard packaging [pce]
T120-L10	M10	10.3	28	12	14	20	35	30.5	14.5	34	19	25	50
T120-L12	M12	12.8	28	16	18	40	50	30.5	14.5	34	19	25	50
T150-L	Range of cable cross section (flexible) [mm ²] 150					Range of cable cross section (low stranded) [mm ²] 150							

tipo	Screw diameter	ØD [mm]	B [mm]	N [mm]	M [mm]	Tightening torque (high conductivity screw) [nm]	Tightening torque (8.8 grade screw) [nm]	A [mm]	Ø [mm]	Cable stripping length [mm]	Ø1 [mm]	Unit in minimal packaging [pce]	Unit in standard packaging [pce]
T150-L10	M10	10.3	30	12	14	20	35	35	16.2	39	21	10	40
T150-L12	M12	12.8	30	16	18	40	50	35	16.2	39	21	10	40

T185-L

Range of cable cross section (flexible) [mm²]
185

Range of cable cross section (low stranded) [mm²]
185

tipo	Screw diameter	ØD [mm]	B [mm]	N [mm]	M [mm]	Tightening torque (high conductivity screw) [nm]	Tightening torque (8.8 grade screw) [nm]	A [mm]	Ø [mm]	Cable stripping length [mm]	Ø1 [mm]	Unit in minimal packaging [pce]	Unit in standard packaging [pce]
T185-L10	M10	10.3	33	12	14	20	35	37	18	41	23	10	40



Via Serenissima, 9 - 25135
Brescia - ITALY